



August 2017

■ **MxIRLight Series**

PoE-powered high-caliber infrared illuminator for MOBOTIX cameras with B&W sensor, available with six different illumination angles compatible with the MOBOTIX lenses B036 to B237

■ **MxSplitProtect and MxSplitProtectHR**

Weatherproof installation box with separate DIN rail module including surge protection for connection to IP cameras/PoE devices using one Ethernet installation cable

■ **MxManagementCenter (MxMC) Version 1.5**

Multi-camera configuration, improved performance on large project data

■ **MOBOTIX App Version 1.4.1 (Update For iOS 11)**

64-bit version

■ **MxDisplay+ Firmware Version 2.3.0.18**

New functions and improvements

■ **Product and Service Discontinuations as of 31 October 2017**

Black colored Q25 Hemispheric cameras, end of service for x22/x12 cameras



Contents

New MOBOTIX Products From August 2017

Page

| | |
|---|----|
| 1. MxIRLight Series | 3 |
| 2. MxSplitProtect and MxSplitProtectHR | 6 |
| 3. MxManagementCenter (MxMC) Version 1.5 | 10 |
| 4. MOBOTIX App Version 1.4.1 (64 Bit) | 11 |
| 5. MxDisplay+ Firmware Version 2.3.0.18 | 12 |
| 6. Product and Service Discontinuations as of 31 October 2017 | 13 |
| 7. Schedule | 14 |

Please note: The following document is solely intended for MOBOTIX partners as information and to assist in demand planning and may not be published in its current format (in digital form or as a hard copy).

General Notes: Sold to distributors or commercial clients only • Prices excluding VAT/sales tax ex-factory Langmeil, Germany • MOBOTIX is not responsible for any errors or omissions in this document
© MOBOTIX AG 2016

Copyright Notice: All rights reserved. MOBOTIX, the MOBOTIX AG logo and MxAnalytics are trademarks of MOBOTIX AG registered in the European Union, the U.S. and in other countries.



1. MxIRLight Series



MOBOTIX Infrared Illuminator: PoE-powered, Illumination Angle From 15° To 120°, Very Simple Installation

Thanks to their above-average light-sensitive 6MP Moonlight image sensors, MOBOTIX cameras are capable of being used even in difficult light conditions, and often even without artificial additional lighting. The new, cost-efficient, long-lasting MxIRLight Infrared Illuminators featuring low-power LED technology (max. 9 W, PoE+ standard) have proven to be worthwhile in very dark or completely dark applications with lighting lower than 3–5 lux (in comparison, street lights provide 10 lux). This especially applies for video installations requiring high image resolution and intelligent analysis functions such as MxActivitySensor or external license plate capture. The light produced by the MxIRLight Illuminator generates an infrared wavelength of 860 nm that is perfectly perceptible by a MOBOTIX camera with a **black/white** image sensor, yet only perceptible to the human eye as a red glimmer, in contrast to conventional white lights. **Note:** The combination of color sensor and MxIRLight does not change the image because this sensor is equipped with an IR blocking filter for maximum image quality by day.

Six Weatherproof Models For Outdoor Applications (IP67)

MOBOTIX offers six different powerful MxIRLight Illuminators featuring the same compact, solid aluminum housing (H x B x T: 90 x 115 x 51 mm). The difference between the illuminators lies in their **illumination angle** (horizontal & vertical: 120°, 90°, 60°, 45°, 30°, 15°) and their **maximum range*** (20 m, 35 m, 50 m, 80 m, 120 m, 160 m). The smaller the illumination angle, the narrower the lighting yet the longer the reach. The illuminator should be paired with the image angle of the camera lens in use.



* max. range also depends on the reflection behavior of the area/structures under illumination

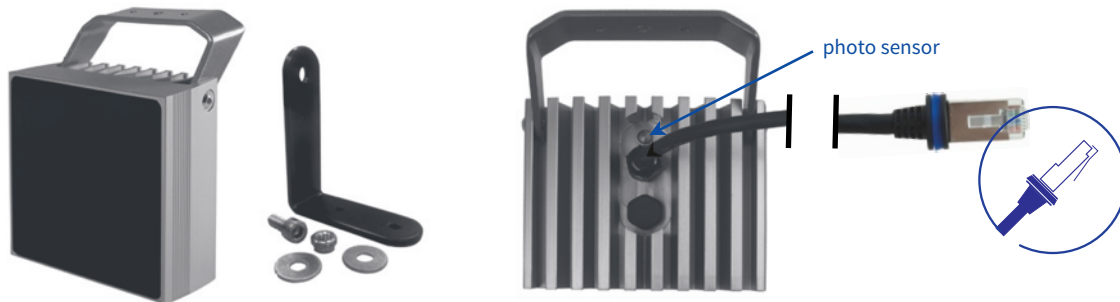

Simple Installation And Operation

There is a robust universal bracket on the illuminator (screw connection) as standard. It can be expanded using the supplied L bracket to enable any standard installation option:



The MxIRLight is also fitted with a 90-cm cable with a MOBOTIX RJ45 connector, enabling users to have a weatherproof means to connect the device to the **MxSplitProtect** without further equipment.

Commercial connectors (with weatherproof housing) or the MOBOTIX MX- Overvoltage-Protection-Box can be used together with the MOBOTIX RJ45 connector for a weatherproof connection directly to an Ethernet cable, which is used by the MxIRLight for PoE+ power supply (IEEE 802.3at).

Thanks to the **photosensor** on the back of the device, the MxIRLight automatically switches on and off (once connected) when the sensor detects light conditions above/below the threshold of **3 lux**. Switching off is after **150 seconds**, so that IRLight does not switch off if the light increases briefly due to flashlights, headlights, lightning etc. When the IR illuminator is installed, the photosensor should not be covered or shaded too greatly or be exposed to light sources that focus on the sensor but not the camera's surveillance area.

Accessories: Mounting Brackets For The MOBOTIX M15/M16 And M25/M26 Cameras

MOBOTIX offers two installation sets with brackets in white aluminum (Mx-M-IRA-ML and Mx-M-IRA-M) as an accessory; they are also an elegant means to install the MxIRLight on the VarioFlex wall mount of an M15/M16 AllroundDual camera or M25/M26 Allround camera.





Mx-A-IRA-120/90/60/45/30/15



Mx-M-IRA-ML



Mx-M-IRA-M

MxIRLight Infrared Illuminators: Ordering Information

| Order Number | EAN | Description | MSRP | Available |
|--------------|---------------|---|-------|-------------|
| Mx-A-IRA-120 | 4047438030342 | Infrared illuminator with 120° illumination angle (horizontal and vertical), aluminum housing • 860 nm • IP67 • Range: up to 20 m • PoE+ power supply via network cable (IEEE 802.3at), 19 W (max.) power consumption • Photosensor for automatic switching on/off (threshold value: 3 lux, delay for switching off: 150 s) • Including standard mount for installing on wall and ceiling, screws, preassembled 0.9 m patch cable with RJ45 connector and MOBOTIX special sealing ring • Optional accessories: mounting brackets for M1x/M2x (Mx-M-IRA-ML/Mx-M-IRA-M) • Housing color: white | 239 € | 21 Aug 2017 |
| Mx-A-IRA-90 | 4047438030342 | Infrared illuminator with 90° illumination angle (horizontal and vertical), aluminum housing • 860 nm • IP67 • Range: up to 35 m | 239 € | 21 Aug 2017 |
| Mx-A-IRA-60 | 4047438030342 | Infrared illuminator with 60° illumination angle (horizontal and vertical), aluminum housing • 860 nm • IP67 • Range: up to 50 m | 239 € | 21 Aug 2017 |
| Mx-A-IRA-45 | 4047438030342 | Infrared illuminator with 45° illumination angle, (horizontal and vertical) aluminum housing • 860 nm • IP67 • Range: up to 80 m | 239 € | 21 Aug 2017 |
| Mx-A-IRA-30 | 4047438030342 | Infrared illuminator with 30° illumination angle (horizontal and vertical), aluminum housing • 860 nm • IP67 • Range: up to 120 m | 239 € | 21 Aug 2017 |
| Mx-A-IRA-15 | 4047438030342 | Infrared illuminator with 15° illumination angle (horizontal and vertical), aluminum housing • 860 nm • IP67 • Range: up to 160 m | 239 € | 21 Aug 2017 |

MxIRLight Mounting Brackets For M1x And M2x: Ordering Information

| Order Number | EAN | Description | MSRP | Available |
|--------------|---------------|---|------|-------------|
| Mx-M-IRA-ML | 4047438030403 | Mounting brackets for the MOBOTIX M15/M16 AllroundDual cameras • Accessories for the MxIRLight Infrared Illuminator • Material: aluminum • Color: white | 18 € | 21 Aug 2017 |
| Mx-M-IRA-M | 4047438030410 | Mounting brackets for the MOBOTIX M25/M26 Allround cameras • Accessories for the MxIRLight Infrared Illuminator • Material: aluminum • Color: white | 18 € | 21 Aug 2017 |

2. MxSplitProtect and MxSplitProtectHR



MxSplitProtect: Versatile Installation Box For Outdoor Applications (IP66)

The MxSplitProtect enables users to connect a maximum of two IP/PoE devices using one Ethernet cable to the supplying PoE switch – weatherproof and protected against power surges. In addition to new installations, you can cost-effectively make expansions to existing video surveillance systems, such as installing a second IP camera or a PoE infrared illuminator to a pole with an IP camera already. The MxSplitProtect offers a simple means of adding an additional Ethernet cable from the PoE switch in the electrical cabinet to the pole.

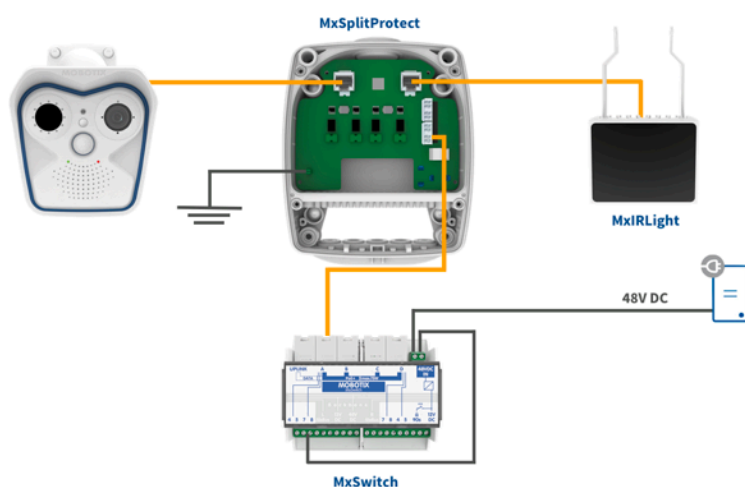

Split Function: An MxSwitch (MX-SWITCH) is installed in the electrical cabinet to connect a MOBOTIX camera with the MxIRLight Infrared Illuminator. It is supplied with power via a 48-V power supply unit (2 A min.) and as a **MOBOTIX Switch special feature**, it uses separate wires to supply the power required by the camera and IR illuminator via the installation cable in order to supply both MxSplitProtect ports (left: data and power for the camera; right: power only for the IR illuminator). A **standard PoE switch is not suitable for such applications.**



Protect Function:

In addition to providing **two RJ45 sockets** to connect the network devices via the MOBOTIX patch cable (MX-OPT-CBL-LAN, permitted length: max. 1 m), an **LSA terminal connector** to connect the 8-wire Ethernet installation cable and the terminal connector for the ground wire, the MxSplitProtect provides effective **surge protection of up to 4 kV on the PoE cable**.

Please note:

The MxSplitProtect protects against **surges of up to 4 kV** on an Ethernet cable, but not against direct lightning strikes (which exceed 4 kV!). A specialist should establish a surge protection concept and implement such a system in order to reduce the danger of damage as much as possible.



Weatherproof bayonet fastening for MOBOTIX RJ45 connectors

| MxSplitProtect: Ordering Information | | | | |
|--------------------------------------|---------------|--|-------|-------------|
| Order Number | EAN | Description | MSRP | Available |
| Mx-A-SPA | 4047438030229 | Weatherproof installation box with integrated 4-kV surge protection for connection (Type 2 P4) to two IP cameras/PoE devices using one Ethernet cable • Interfaces (weatherproof): 1 LSA (with shield clip) for Ethernet 2 100Base-T, 2 MxRJ45 for Ethernet 100Base-T with PoE Mode A, 1 protective earth terminal • IP66 and IK08, ambient temperature: -30°C to 60°C (-22°F to 140°F) • Accessories (available separately): MxSplitProtectHR DIN rail module (Mx-A-SPA-HR), cover with camera mount in three versions (Mx-A-SPCA-M/-H/-V), pole mount (MX-MH-SecureFlex-ESWS) • Housing color: white | 178 € | 21 Aug 2017 |



Mounting Instructions: The pole mount of the M1x/M2x cameras can also be used (diameters from 6 to 18 cm) to install the MxSplitProtect to a pole (MX-MH-SecureFlex-ESWS).



MxSplitProtectHR: DIN Rail Module For The Electrical Cabinet

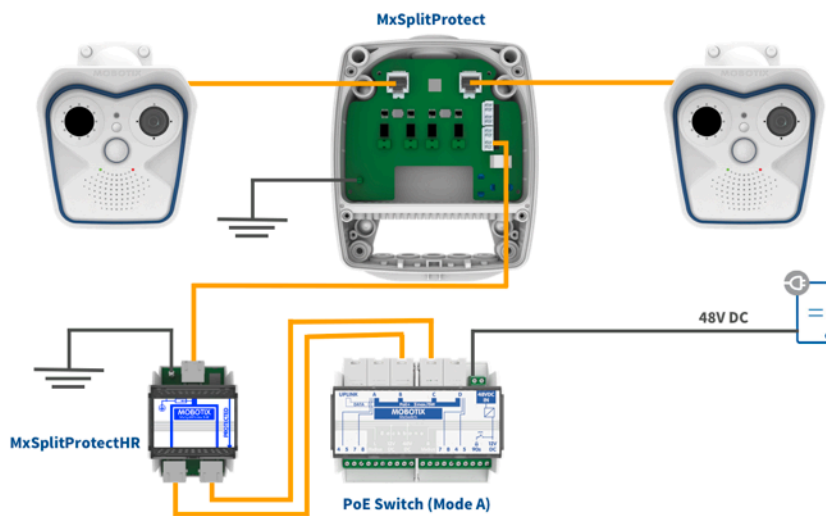

The MxSplitProtectHR DIN rail module is required (usually in the electrical cabinet), in addition to a PoE switch with PoE Mode A (for example, the MxSwitch) with two free ports, in order to connect two PoE-powered network devices (such as two MOBOTIX cameras) with the MxSplitProtect via one Ethernet installation cable with power. It transfers **data and power from both PoE ports** (each using only four wires) to the eight-wire installation cable, which is then split again between the

MxSplitProtect Installation Box's two RJ45 ports. The MxSplitProtectHR DIN rail module offers the same split feature and 4-kV surge protection like the MxSplitProtect; however, it is not weatherproof. In addition, instead of an LSA terminal connector, there is an RJ45 socket for connecting the Ethernet installation cable because the wires of the installation cable in the electrical cabinet are normally wired for a patch panel that is then connected with the MxSplitProtectHR via patch cable and RJ45 connector.



Please Note: Instead of combining the MxSplitProtect and MxSplitProtectHR, it is also possible to combine two MxSplitProtectHRs (potentially using a customer protective device; for example, against dust, dirt, humidity in the room) in order to use the above-mentioned Split and Protect features **indoors** (0°C to 40°F/32°F to 104°F). For example, an additional camera or an IR illuminator can be installed on the ceiling in a warehouse building, but there is only an Ethernet cable available.



Connections on the Mx-A-SPA-HR (two views of device): 2 RJ45 to the switch (for two PoE devices) and 1 RJ45 (to the patch panel)

| MxSplitProtectHR: Ordering Information | | | | |
|--|---------------|--|------|-------------|
| Order Number | EAN | Description | MSRP | Available |
| Mx-A-SPA-HR | 4047438030236 | Compatible with MxSplitProtect Installation Box (Mx-A-SPA): Hat rail module (for 35 mm DIN rails) with integrated 4-kV surge protection (Type 2 P4) for connection to two IP cameras/PoE devices using one Ethernet cable • Interfaces: 3 RJ45 for Ethernet 100Base-T for PoE Mode A, 1 protective earth terminal • Only use in indoor areas, ambient temperature: 0°C to 40°C (32°F to 104°F) • Accessories (available separately): MxSwitch (MX-SWITCH1) • Housing color: gray | 78 € | 21 Aug 2017 |



MxSplitProtect Covers With Camera Mount (Installation Accessories, Three Versions)

MOBOTIX offers three different covers with an integrated camera mount for the MxSplitProtect Installation Box to further simplify the installation of the camera and to protect the RJ45 sockets from direct access. A MOBOTIX M15/M16/M25/M26 camera with a standard VarioFlex wall mount or a MOBOTIX Q25/Q26/D25/D26 camera can be mounted to it either horizontally or vertically with a 15° tilt. If there is already a pole mount of an M1x/M2x in use, it can also continue to be used for the MxSplitProtect (see Mounting Instructions on page 7). The MxSplitProtect can also be used outdoors without this cover, thanks to its robust housing made of UV-resistant PBT-30GF and weatherproof connections for the Ethernet cable (concealed LSA terminal connector inside the housing) and for the MOBOTIX patch cable of the cameras and the MxIRLight (see Figure, right).



| MxSplitProtect Covers: Ordering Information | | | | |
|---|---------------|---|------|-------------|
| Order Number | EAN | Description | MSRP | Available |
| Mx-A-SPCA-M | 4047438028820 | Cover/mounting option with camera mount • Accessories for the MxSplitProtect Installation Box (Mx-A-SPA) • Also possible to install the standard VarioFlex wall mount of an M15/M16/M25/M26 camera directly to the cover • Color: white | 28 € | 21 Aug 2017 |
| Mx-A-SPCA-V | 4047438028844 | Cover/mounting option with camera mount • Accessories for the MxSplitProtect Installation Box (Mx-A-SPA) • Also possible to (vertically) install a Q2x (or D2x) camera with a 15° tilt angle without an additional mount directly to the cover • Color: white | 28 € | 21 Aug 2017 |
| Mx-A-SPCA-H | 4047438028837 | Cover/mounting option with camera mount • Accessories for the MxSplitProtect Installation Box (Mx-A-SPA) • Also possible to (horizontally) install a Q2x/D2x camera without an additional mount directly to the cover • Color: white | 28 € | 21 Aug 2017 |



3. MxManagementCenter (MxMC) Version 1.5

MxManagementCenter is the powerful, easy-to-use MOBOTIX video management system for Windows and Apple computers. Following beta testing, MxMC 1.5 is now available free of charge with the following features:



Multi-Camera Configuration (Multi-Edit)

The edit mode of the device bar now allows selecting several cameras at once (using [Shift]-click or [Ctrl]-click) and right-click to open the

new Multi-Camera Configuration dialog. This dialog also allows setting the most important properties for all selected cameras at once, such as the camera access data (user name and password) or the recording path.

Performance on Large Project Data

The system behavior and the response times when working with large project data (several hundred cameras) has been improved. This is most noticeable when using the device bar on the left-hand side of the application window, e.g., when switching grids.

The MxMC Version 1.5, including a detailed description (in the release notes), can be downloaded free of charge from the MOBOTIX website.

MxManagementCenter 1.5 For Windows And Mac OS X

Download: www.mobotix.com > Support > Software Downloads > MxMC

| Description | Release | MSRP | Available |
|---|----------|------|-----------|
| MOBOTIX MxManagementCenter (MxMC) video management software • Version 1.5 for Windows (Vista or higher) and Version 1.5 for Mac OS X (10.7 or higher) • Language packs: English, German, French, Spanish, Italian, Russian, Turkish, Portuguese, Japanese • System requirements: 2 GHz processor (min.), at least 2 GB RAM, video card with support for OpenGL V2.1 • Download free of charge: www.mobotix.com > Support > Software Downloads > MxManagementCenter | MxMC 1.5 | 0 € | Now |



4. MOBOTIX App Version 1.4.1 (64 Bit)

The MOBOTIX App Version 1.4.1 is available for download from the App Store as a **64-bit Version**. Owners of MOBOTIX IP Video Door Stations and MOBOTIX IP Cameras can also continue to use this App with **iOS 11** on their iPad, iPad mini, iPad Pro, iPhone or iPod free of charge.

New Features Available In Version 1.4.1

- 64-bit version, compatible with iOS 11
- Multilingual online help
- Buttons (Alarm, Bell, Messages) now also available in portrait mode
- Various bug fixes



System Requirements

- > iPad/iPad mini/iPad Pro/iPhone/iPod touch, iOS 6.0 and higher
- > MOBOTIX IP Video Door Station, firmware 4.1.4.70 and later
- > MOBOTIX IP camera, firmware 4.1.4.70 and later

Notes:

- Even if you do not yet have a MOBOTIX device (Door Station or camera), you can test the App using the integrated demo videos.
- Our new app, **MxBell**, which will be available for Android and iOS devices alongside the existing App, has entered the final development phase. The first version has been specially designed for the MOBOTIX T25 Door Station and includes all features such as “Live view of the Door Station including audio,” “Open door” and “Live view with bandwidth optimization” on other MOBOTIX cameras. The option to send doorbell notifications via push notifications when there is an Internet connection is another new feature. MxBell and the firmware updates for the associated Door Stations and cameras are planned to be released in the next few weeks.
- Furthermore, a variety of third-party apps is also available to support MOBOTIX cameras on mobile devices. For example, the QCamPro app, which is designed for MOBOTIX and other products, offers a paid push notification service. Please bear in mind that we cannot provide technical support for the software products offered by technology partners.



5. MxDisplay+ Firmware Version 2.3.0.18



The currently available white or black MxDisplay+ devices (order numbers: MX-DISPLAY3 and MX-DISPLAY3-b for indoor versions and MX-DISPLAY3-EXT and MX-DISPLAY3-EXT-b for outdoor versions) get a new firmware V2.3.0.18, which can also be installed on already delivered MxDisplay+ devices with the above-mentioned order numbers.

New MxDisplay+ functions with the new firmware 2.3.0.18:

- Support of MxMessageSystem: Sending and receiving of MxMessageSystem messages
- Function "Room thermostat": Automated, ambient temperature-dependent control of one or more heating thermostats
- Door bell signalling via MxMessageSystem messages (for "larger installations") in order to connect any number of MxDisplay+ devices to the same MOBOTIX IP Video Door Station
- Bugfixes and further enhancements

The MxDisplay+ Firmware Version 2.3.0.18, including a detailed description (in the release notes), can be downloaded free of charge from the MOBOTIX website.

MxDisplay+ Release 2.3.0.18

Download: www.mobotix.com > Support > Software-Downloads > MxDisplay > MxDisplay+ Release 2.3.0.18

| Description | Release | MSRP | Available |
|---|----------|------|-----------|
| Firmware for all MOBOTIX MxDisplay+ devices with the order numbers MX-DISPLAY3, MX-DISPLAY3-b, MX-DISPLAY3-EXT and MX-DISPLAY3-EXT-b • Free of charge download: www.mobotix.com > Support > Software Downloads > MxDisplay | 2.3.0.18 | 0 € | Now |

Please note: In order to use the MxDisplay+ with this new firmware, all the MOBOTIX door stations and other cameras need to run a software release **V4.4.2.69** or higher, which can also be downloaded for free from the MOBOTIX website (www.mobotix.com > Support > Software Downloads > Cameras).



6. Product and Service Discontinuations as of 31 October 2017

End-of-Life (EoL) for black Q25 models with 6MP Moonlight sensor

We have decided to discontinue the black Q25 models (day or night) and their matching black in-ceiling set as of 1 November 2017 (EOL – End-of-life) due to reduced demand. The discontinued products can be ordered until **31 October 2017 or until supplies last**. The white Q25 models are still available for ordering.



Q25 6MP Cameras In Black: Discontinued Product (EOL)

| Order Number | EAN | Short Description | Discontinued (End-of-life) |
|---------------|---------------|---|----------------------------|
| MX-Q25-D016-b | 4047438025867 | Q25 Complete camera 6MP, B016, day, black | 31 Oct 2017 |
| MX-Q25-N016-b | 4047438025874 | Q25 Complete camera 6MP, B016, night, black | 31 Oct 2017 |
| MX-OPT-IC-BL | 4047438013970 | In-ceiling set for Q2x, black | 31 Oct 2017 |

End-of-Service (EoS) for x22 cameras and service reductions for x12 Kameras

As the production of the camera models D22, M22 and Q22 ended more than eight years ago and several technical components are no longer available, MOBOTIX will discontinue the repair service for all x22 cameras on **31 October 2017**. Also, the repair service for the camera models M12, D12 and V12 has to be restricted due to limitations of availability of some components (limitations depend on camera model and need for repair).



7. Schedule

New Hardware – now available for order (applies to MOBOTIX partners and end customers):

| | |
|------------------|---------------------------------------|
| MxIRLight | Shipping as of Monday, 21 August 2017 |
| MxSplitProtect | Shipping as of Monday, 21 August 2017 |
| MxSplitProtectHR | Shipping as of Monday, 21 August 2017 |

New Software – Availability on the MOBOTIX website:

| | |
|---|--------------------------------|
| MxManagementCenter 1.5 | Download as of now |
| MOBOTIX App 1.4.1, 64-bit version for iOS | Now available in the App Store |
| MxDisplay+ firmware version 2.3.0.18 | Download as of now |

All New Products on the MOBOTIX website (starting August 2017):

| | |
|---|-----------------------------------|
| www.mobotix.com > Products | (for hardware) |
| www.mobotix.com > Support > Software Downloads | (for software) |
| www.mobotix.com > Support > Manuals | (Manuals/Quick Installs) |
| www.mobotix.com > Partners > Partner Section* > Price List | (Updated price list for download) |

*only available in the partner section, registration/login required

Product Training Seminars:

The current dates can be found on the MOBOTIX website under Partners > Seminars.

Webinar on this Product Announcement (duration approx. 30 minutes, language: English):

| | |
|-----------------------------------|--|
| Wednesday, 16 August 2017 – 9:00 | 9 a.m., Central European Summer Time CEST (German Time) |
| Wednesday, 16 August 2017 – 16:30 | 4:30 p.m., Central European Summer Time CEST (German Time) |

Please register...

... for the 9:00 session using this link: <https://register.gotowebinar.com/register/1234695867131450882>

... for the 4:30 session using this link: <https://register.gotowebinar.com/register/6290523010529195778>